

NOTES:

1. METALSHELLS: STEEL; min. 315µin TIN over 40-80µin NICKEL
2. INSULATORS: PBT GF UL 94 V-0; BLACK
3. CONTACTS: COPPER ALLOY; PLATING (SEE PART NO.):
 PLEASE ADD 1 for 30µin HARD GOLD over min. 50µin NICKEL
 PLEASE ADD 3 for GOLD FLASH over NICKEL
4. SNAP-LOCK AND SPACER CLIPS: COPPER ALLOY;
 min. 200µin TIN over 80µin NICKEL
 PCB-HOLE: $\varnothing 3,1 \pm 0,1$ mm; PCB-THICKNESS: 1,6mm
5. COLLARS: COPPER ALLOY; min. 200µin over 80µin NICKEL
6. P.C.B. HOLE DRILLINGS ON SHEET 2
7. CONNECTOR IS PART MARKED: **16-00216 CONEC ABC**

Directive 2002/95/EC RoHS compliant

THIS DRAWING MAY NOT BE COPIED OR REPRODUCED IN ANY WAY, AND MAY NOT BE PASSED ON TO A THIRD PARTY WITHOUT WRITTEN PERMISSION. OWNERSHIP AND COPYRIGHT OF CONEC GmbH DO NOT ALTER CAD DRAWING BY HAND				tolerance	dim. in mm	scale:	2:1 (5:1)			
							material:	SEE NOTES		
				date	name	title: D-SUB FEMALE 25pos. SOLDER PIN STRAIGHT with snap-lock and spacer clip				
				drawn	01.10.14					Henneboel
				appd.	01.10.14					Strakerjahn
				norm						
				d-old			dwg no:		DIN-A3	
a	Original						16K1A3541	sh: 1/2		
rev.	description	date	name	CONEC [®]		part no:	16-00216 <input type="checkbox"/> (see note 3)			

P.C.B. HOLE DRILLINGS
(P.C.B. TOP SIDE)

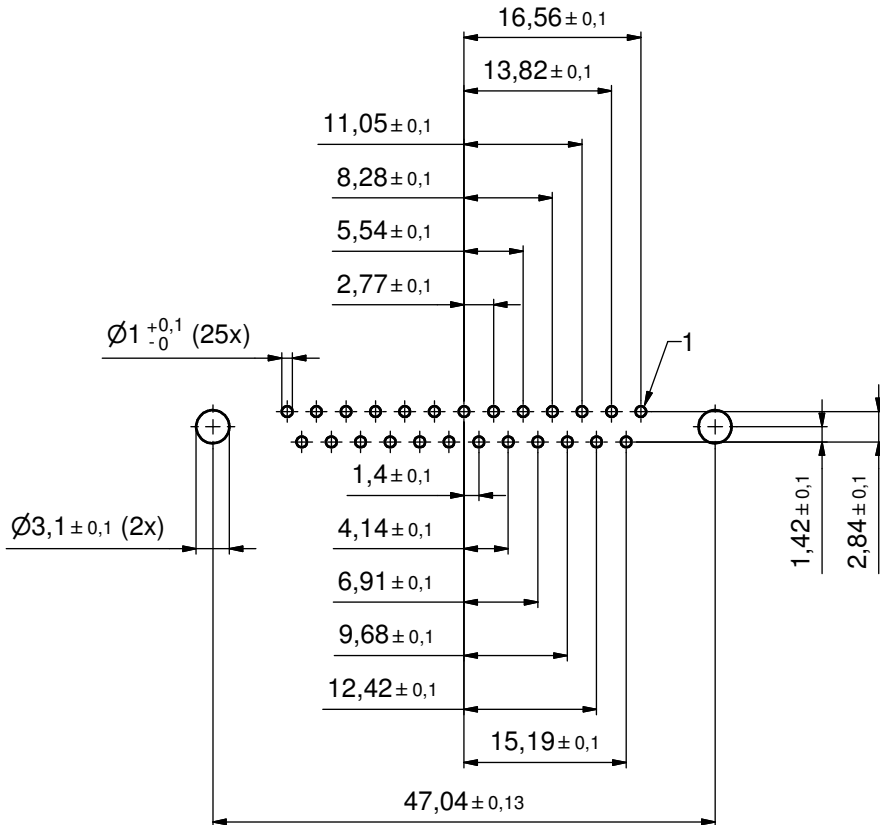

THIS DRAWING MAY NOT BE COPIED OR REPRODUCED IN ANY WAY, AND MAY NOT BE PASSED ON TO A THIRD PARTY WITHOUT WRITTEN PERMISSION. OWNERSHIP AND COPYRIGHT OF CONEC GmbH DO NOT ALTER CAD DRAWING BY HAND				tolerance		scale: 2:1	
				date	name	material: SEE SHEET 1	
				drawn	01.10.14	Henneboel	title: P.C.B. HOLE DRILLINGS D-SUB FEMALE 25pos. SOLDER PIN with snap-lock and spacer clip
				appd.	01.10.14	Strakerjahn	
				norm			
				d-old			dwg no:
	a	Original		CONEC [®]			16K1A3541
rev.	description	date	name				part no: SEE SHEET 1