

Schematic

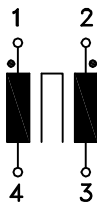

Viewed on component side

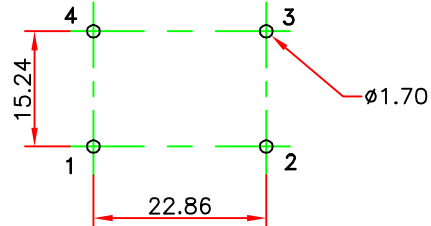

TECHNICAL DATA :

- Core : toroid Ø31 / Ø19 / H12 μ i 6000 ferrite material or equivalent
- Wire : Ø1.18 grade 1 class F or equivalent
- Rated current per winding : 16A referred to 250V – 50Hz and +60°C ambient temperature
- Inductance value per winding : 2.7mH –30% + 50% at 10KHz , 0.1mA
- Test voltage between winding : 1500VAC – 50Hz , 2 sec.
- Climatic category : DIN GKS (–40° to +125°C; humidity cat.C)
- Socket material : PBT at 30% fibreglass UL94–V0 or equivalent

RoHS compliance

Please, refer to general catalog for unspecified parameters

a	
IND	DATE

Radiohm Specification

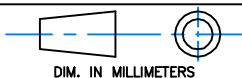

Designation : 32V31 A600 SV3

Part number : _____ Date : 24/11/2011

Preliminary : Final :

Customer Specification Approval

Part number : _____

Signature : _____ Name : _____ Title : _____ Date : _____