

Motor GM25-370-11670-500-12D8 Art.-Nr.: 860525

Specification :

Item	Unit	Specification
Rated voltage	V _{DC}	12.0
Gear Ratio		1/226
Rotation		CW&CCW
Motor Position		All position in horizontal
Temperature	°C	0~30
Humidity	%	30~95
• Performance of Motor		
No-load Speed	rpm	3.000±10%
No-load Current	mA	40 (max.)
Stall Current	mA	500 (max.)
Stall Torque	g.cm	80
• Performance of Gear motor		
Output Speed	rpm	13±10%
No-load Current	mA	50 (max.)
Stall Current	mA	500 (max.)
Stall Torque	kg.cm	13
Rated Torque	g.cm	4000
Rated Current	mA	220 (max.)
Noise	dB	52
• The Dimension		
The Outside Shaft Length	mm	12
Shaft End Play	mm	0.05-0.50
Screw Size		M3
Dia of Shaft	mm	Ø4*D3.5

Motor GM25-370-11670-500-12D8 Art.-Nr.: 860525

Dimensions :

(Unit : mm)

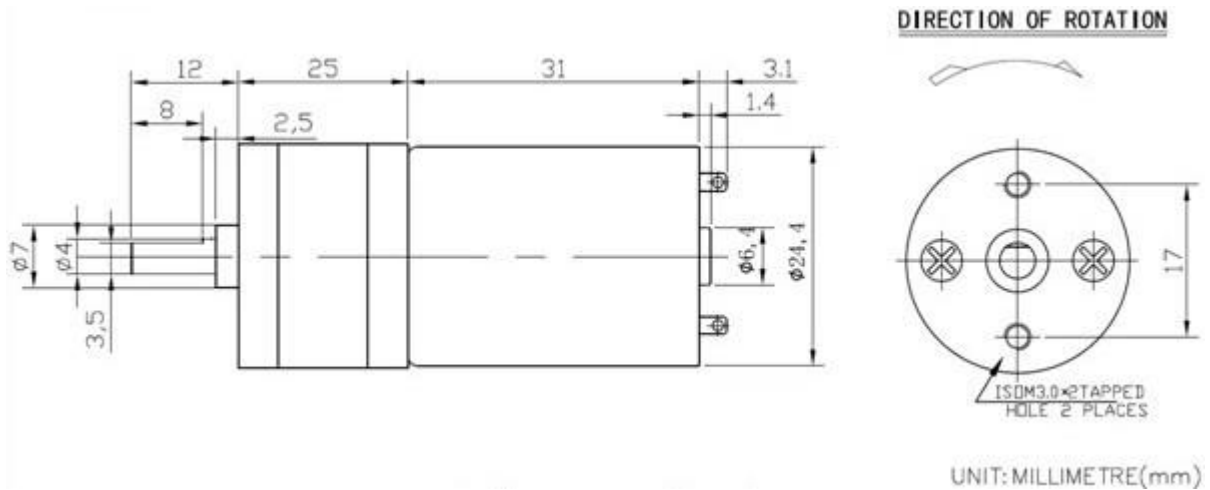

Curve Drawings :

