

1

2

3

4

5

6

7

⑦ USB2.0 COMPLIANT

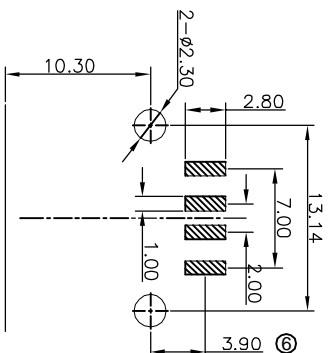
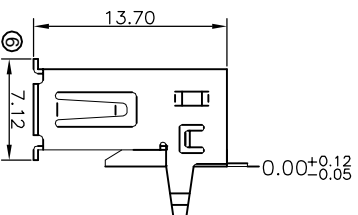
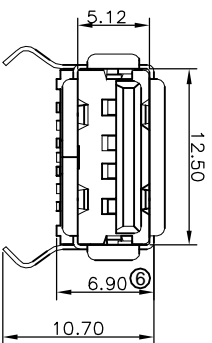
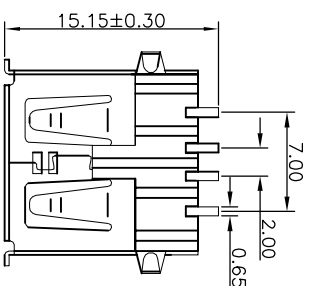
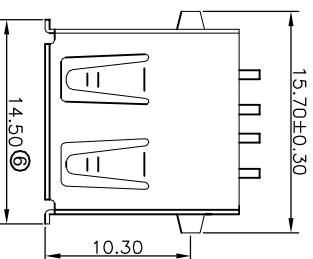
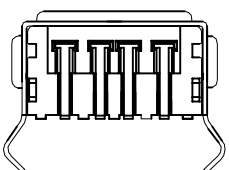

RECOMMENDED P.C.B LAYOUT

- NOTES:**
1. Material:
 - ① 1.1 Housing: LCP+30%GF UL94V-0, Color White
 - 1.2 Shell: Brass
 - 1.3 Contact :Phosphor Bronze
 2. FINISH:
 - 2.1 Contact Area: Gold Flash
 - Solder Area: Tin Plated
 - Under: Ni Plated
 3. MECHANICAL:
 - 3.1 Mating Force: 3.57kgf Max.
 - 3.2 Unmating Force: 1.02kgf Min
 - 3.3 Durability: 1500 cycles Min
 4. ELECTRICAL:
 - ④ 4.1 Current Rating: 1.5A
 - 4.2 Dielectric Strength: 500V AC FOR 1 MINUTE
 - 4.3 Contact Resistance: 30mΩ Max
 - 4.4 Insulation Resistance: 1000 MΩ Min
 5. Operating Temperature: -55°C to +85°C
 - ⑥ 6. Soldering Temperature: +260°C, 10s max.
 7. PACKING:

A-USB A/SMT: Tray
A-USB A/SMT-R: Tape&Reel

RoHS compliant
Unit: mm

Scale	Free	⑨ Update	⑩ Update	06.02.2017	S. Bölling	Customer-No.
TOLERANCE						
X.	±0.5	⑧ Update		08.06.2015	Ray	ASSMANN WSW-No.
X.X	±0.3	⑦ Update		19.08.2013	Winnie	A-USB A/SMT
X.XX	±0.2	⑥ Update		07.06.2013	Winnie	A-USB A/SMT-R
DIM	TOL	⑤ Update		24.04.2012	Lucas	ASSMANN WSW-No.
ANG.	± 5°	④ Add coplanarity		12.07.2011	Jason	A-USB A/SMT-R
Angle	TOL	Id.	Modification	Date	Name	Drawing-No.

ASSMANN
components

ASS 1122D CO rev09

Replace SHEET 1/1

1

2

3

4

5

6

7

H

G

F

E

D

C

B

A

H

G

F

E

D

C

B

A