

1

2

3

4

5

6

7

A

B

C

D

E

F

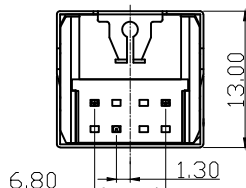
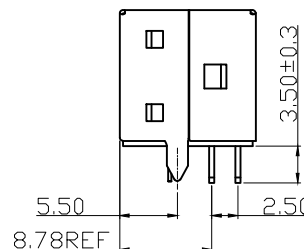
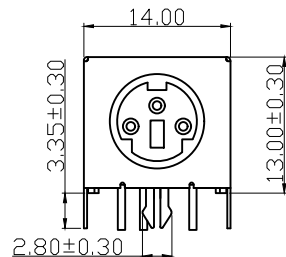

1.Material:  
 Contacts :Brass  
 Insulator :PBT+30% G.F. UL 94V-0;Black  
 Shell :Brass

2.Mechanical:  
 Mating Force: 45N max.  
 Withdrawal Force: 7N min.  
 Durability: 500 cycles min.

3.Electrical:  
 Current-max[amps] 1.0A  
 Voltage-max[volts] 30V  
 Withstanding Voltage 750V AC  
 Contact Resistance [ohms] 30 milliohms max  
 Insulation Resistance [ohms] 1000 Megohms min

4.Plating:  
 Contacts:Gold Flash Selective over Nickel  
 Shell: Nickel

5.Environmental  
 Temperature Range -55°C~+85°C

Order Code:  
 A-DIO-FSxx  
 Shielded No. of Contacts  
 03 / 04 / 05 / 06 / 07 / 08

A

B

C

D

E

F

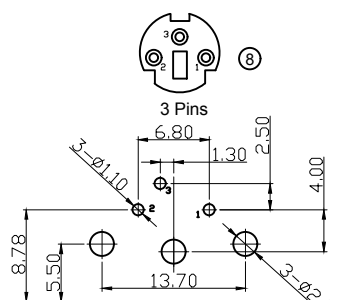

RECOMMENDED P.C.B. PATTERN LAYOUT  
 TOP VIEW (TOLERANCE: ±0.05)

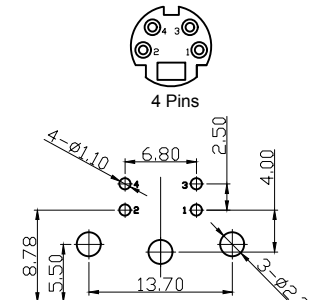

RECOMMENDED P.C.B. PATTERN LAYOUT  
 TOP VIEW (TOLERANCE: ±0.05)

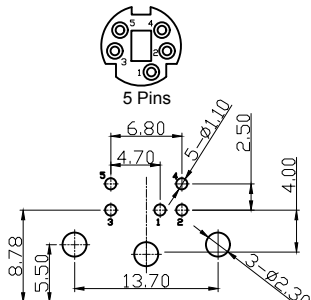

RECOMMENDED P.C.B. PATTERN LAYOUT  
 TOP VIEW (TOLERANCE: ±0.05)

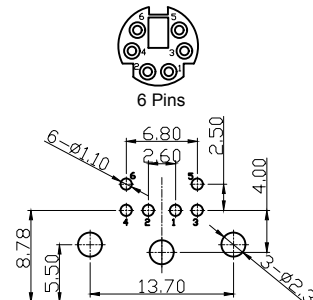

RECOMMENDED P.C.B. PATTERN LAYOUT  
 TOP VIEW (TOLERANCE: ±0.05)

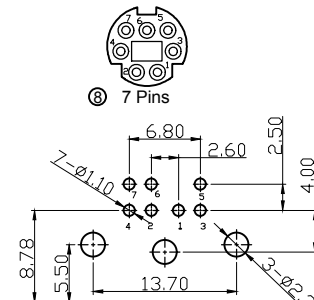

RECOMMENDED P.C.B. PATTERN LAYOUT  
 TOP VIEW (TOLERANCE: ±0.05)

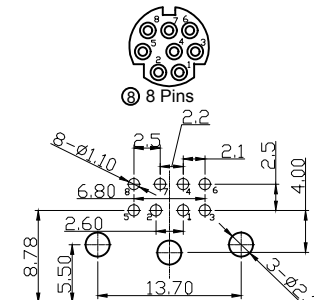

RECOMMENDED P.C.B. PATTERN LAYOUT  
 TOP VIEW (TOLERANCE: ±0.05)

G

H

**RoHS compliant**  
 Unit: mm

Scale	Free	⑧	Correct the PCB layout	11.10.2020	Daniel		Date	Name	Description: MiniDIN Shielded
TOLERANCE		⑦	Add the dimension 4.80	02.03.2016	Winnie	Drawn	19.03.2004	Hellwig	
X.X	±0.38	⑥	Add the dimension 4.00	08.12.2015	Winnie	Approved	11.10.2020	Daniel	
X.XX	±0.25	⑤	Correct the pin out	29.04.2014	Winnie				ASSMANN WSW-No. A-DIO-FSxx
X.XXX	±0.10	④	Update	31.07.2012	Lucas				Drawing-No.
		③	Change the manufacture plant	25.11.2010	Alex				ASS 1622 CO
		Id.	Modification	Date	Name				rev08
X.X°	±3°								Customer-No.

1

2

3

4

5

6

7