

# Schemazeichnung mit Hauptabmessungen/Drawing with principal dimensions

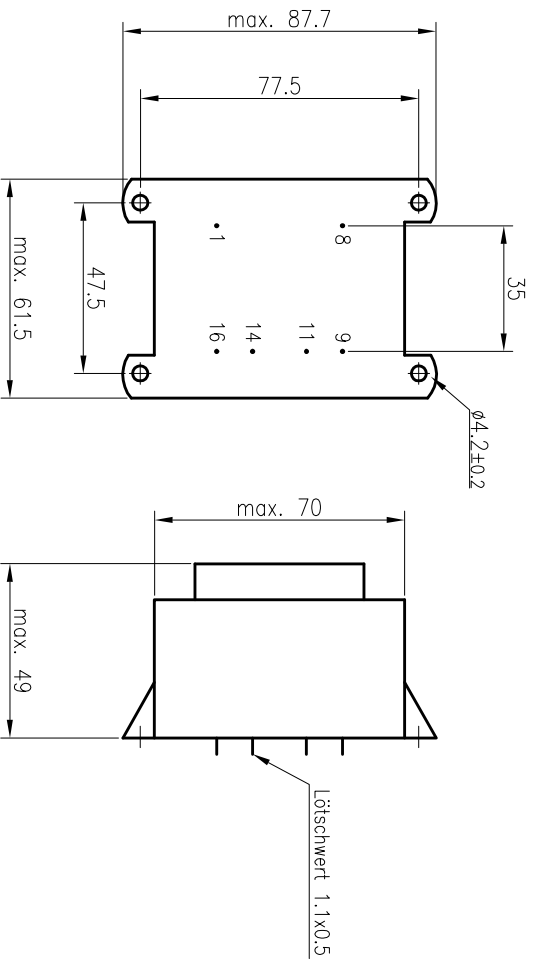

## Anschlusschema/Scheme:

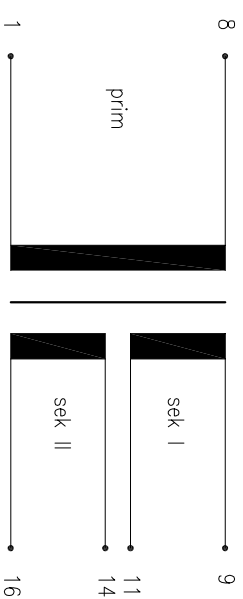





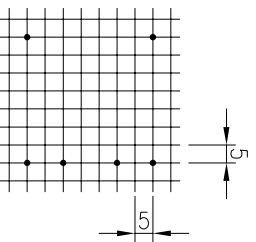

## Elektrische Daten/Electrical Data:

**prim.:** 230V 50-60Hz 1-8  
**sek. I:** 9V 16,5VA 9-11  
**sek. II:** 9V 16,5VA 14-16  
**Temp.-Klasse/class:** ta 70°C/B  
**nicht kurzschlussfest/non short-circuit-proof**

## Raster/Grid: Ansicht:Stiftseite/New:pin side



## Kennzeichnung/Identification: Tampondruck/Pad printing

**prim** 230V 50-60Hz 1-8  
**BV EI 662 1091**  
**ta 70°C/B**  
**HAHN**  **cs**      
**Extern: 2x**  **sek 2,0AT**  
**sek I** 9V 16,5VA 9-11  
**sek II** 9V 16,5VA 14-16  
**①** **⑧**

Unsere Bauteile werden mit einem Data Code (KW: KW/JJ) versehen/Our components are provided with a Data Code (KW: cw/yy)

01	31.08.2020	geändert auf max. Maße		pbl
<b>HAHN GmbH &amp; Co. KG</b>				
Transformator		BV EI 662 1091		

Masse ohne Toleranzangabe ±0,3/Dimensions without tolerances ±0,3mm  
 Unterliegt nicht dem Änderungsdienst/Is not liable to the changing service

Erstellt:	29.07.2003	Jedlinski	Kunde
Geprüft:	29.07.2003	Krätschmer	Ort:
Maßstab:	1:2		Z.Nr.: 3193
Typ:	EI 66/23	-Kk-	Projekt/Art-Nr.:
F:\QAM\CAD\TRAF0-EI\VERG\EI-66\662\BV-EI-662-1091-Serie			