

motor with gear
motorreductor

Reference number Referencia	Nominal voltage Tensión nominal	Nominal torque Par nominal	Nominal speed Velocidad nominal	Nominal current Corriente nominal	Starting torque Par de arranque	Starting current Corriente de Arranque	Shaft Eje	Connections Conexiones	Wiring diag. Esq. eléct.	Transmission ratio Relación de reducción	Approximate weight Peso aproximado	Grado de estanqueidad Watertightness	Wheel material Material rueda	Curve Curva
	Un (V)	Mn (N.m./Lbf.in)	nn (r.p.m.)	In (A)	Ma (N.m./Lbf.in)	Ia (A)				i	P (kg / Lb.t)	IP		
258.1710.20.00	12	15 / 133	25	10	80 / 708	42	E36	C34	F2	52:1	3.00 / 8	IP53	PLA	18
258.1710.30.00	24	15 / 133	25	5	80 / 708	21	E36	C34	F2	52:1	3.00 / 8	IP53	PLA	18
258.3710.20.00	12	15 / 133	25	10	80 / 708	42	E36	C34	EE2	52:1	3.00 / 8	IP53	PLA	18
258.3710.30.00	24	15 / 133	25	5	80 / 708	21	E36	C34	EE2	52:1	3.00 / 8	IP53	PLA	18
258.3712.20.00	12	12 / 106	40	12	80 / 708	55	E36	C34	EE2	52:1	3.00 / 8	IP53	PLA	19
258.3712.30.00	24	12 / 106	40	6	80 / 708	32	E36	C34	EE2	52:1	3.00 / 8	IP53	PLA	19
258.9026.20.00	12	12 / 106	40	12	80 / 708	55	E36	C34	EE2	52:1	3.00 / 8	IP53	CEL	19
258.9026.30.00	24	12 / 106	40	6	80 / 708	32	E36	C34	EE2	52:1	3.00 / 8	IP53	CEL	19

DOGA can develop for you
on this series a customised version:

DOGA puede desarrollar para usted
una versión a medida:

- ▼
- SELF-LOCKING / AUTO-BLOQUEO
- BRONZE WHEEL / RUEDA DE BRONCE
- RESINBONDED WHEEL / RUEDA DE CELOTEX
- FRONT & REAR SHAFT / EJE DELANTERO Y POSTERIOR
- HALL SENSOR / SENSOR HALL
- ▲

and many more / y mucho más
please contact us / por favor contactenos

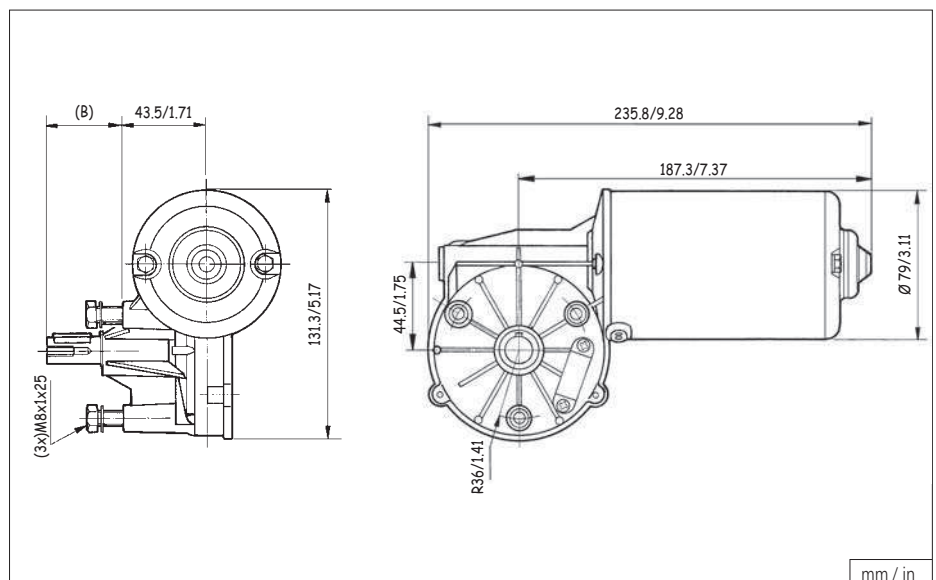

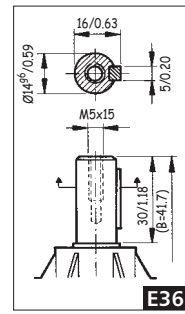

E36

111

CONNECTION - CONEXIÓN

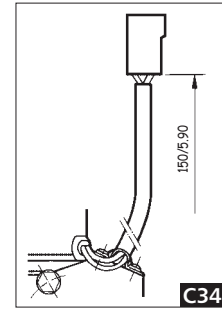

C34

119

210

258

WIRING DIAGRAM - ESQUEMA ELÉCTRICO

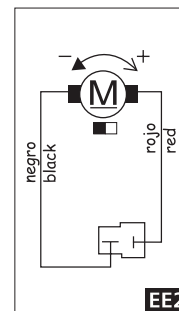

EE2

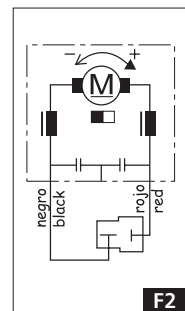

F2

259

316

319

CURVES - CURVAS

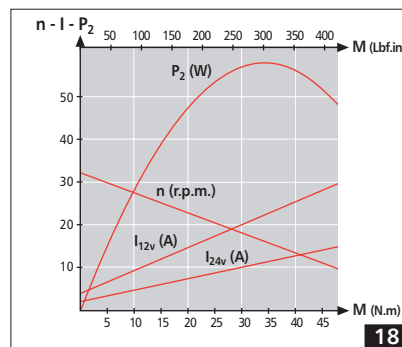

18

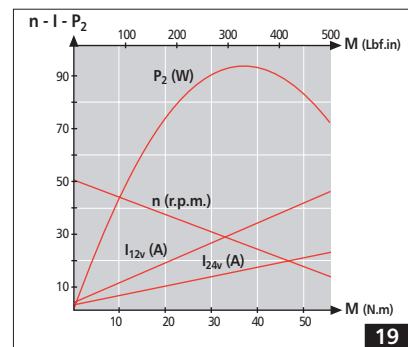

19

162

168

169

260

269