

**Data Sheet**

**Type Number** ..... 6620  
**Designation IEC** ..... CR 1620  
**System** ..... Li-Manganese dioxide / Organic Electrolyte

**UL Recognition**..... MH 13654 (N)  
**Nominal Voltage** ..... 3 V  
**Typical Capacity C** ..... 70 mAh  
 Load 20 kOhm, at 20°C down to 2 V

**Weight (approx.)** ..... 1,2 g  
**Volume** ..... 0,4 ccm  
**Coding**..... Date of Manufacturing Month/Year

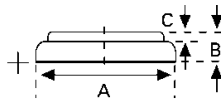

**Temperature Ranges**

	min	max.
Storage .....	-55°C	70°C
Discharge .....	-20°C	70°C*

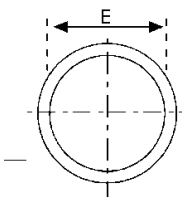

**Dimensions**

	min	max.
Diameter (A) .....	15,70	16,00
Height (B) .....	1,80	2,00
Shoulder Diameter[E].....	12,90	
Shoulder Height [C].....	0,20	

**Typical Capacities (at 20°C)**

Discharge Type	Load	End Voltage:	2.0 V
Continuous 24h/d,7d/w Current [µA]:	20000 Ω	Time: Capacity [mAh]: Energy [mWh]:	500 h 70 200

\* Contact VARTA if the application is intended to be outside the range of -20°C to +70°C.

*Information and contents in this data sheet are for reference purpose only.  
 They do not constitute any warranty or representation and are subject to change without notice.  
 For most current information and further details, please contact your VARTA representative.*

**Data Sheet**
**Performance Data:**

- **Temperature Characteristics\***

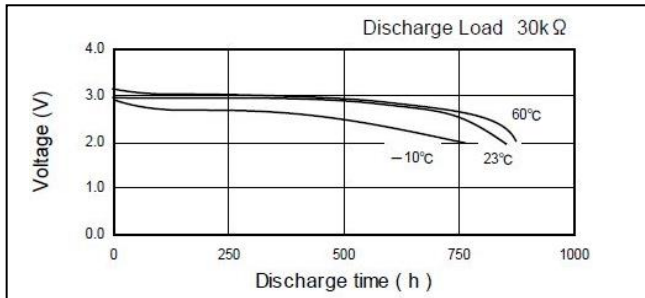

\*Discharge Load 30kΩ

- **Operating Voltage vs. load resistance\***

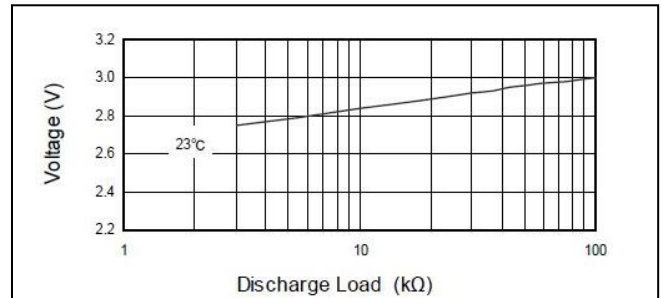

\*Discharge depth 40%

- **Capacity vs. load resistance**

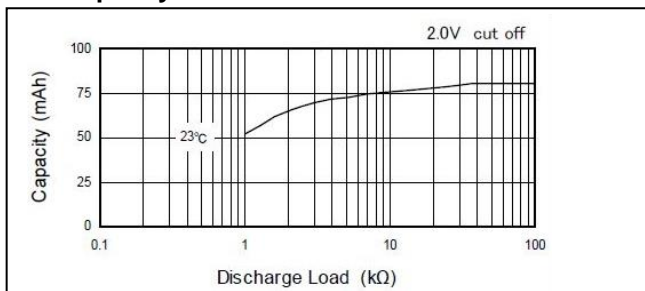

- **Discharge Characteristics**

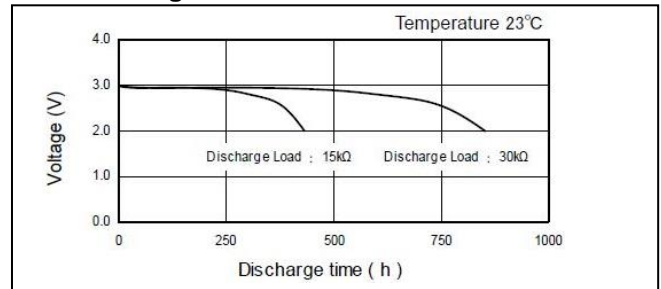

- Self-discharge rate < 1% at room temperature
- Storage life > 10 years
- Operating life\* > 10 years

\* depending on environmental condition and energy consumption

*Information and contents in this data sheet are for reference purpose only.  
They do not constitute any warranty or representation and are subject to change without notice.  
For most current information and further details, please contact your VARTA representative.*