

Bestellbeispiel:

DE17-3007DB

SPACER BOLT

Distanzbolzen

Innen-/Innengewinde

Messing vernickelt

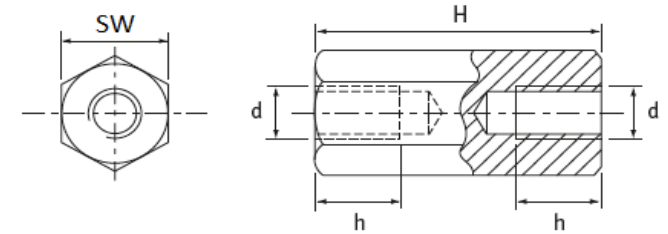

| d<br>mm   | SW<br>mm | H<br>mm | h<br>mm | Stand.-Packg. | Artikel-Nr.<br>Part-No. |
|-----------|----------|---------|---------|---------------|-------------------------|
| <b>M3</b> | 5.5      | 5       | 2.5     | 100           | <b>DE17-3007DBM35</b>   |
|           | 5.5      | 8       | 4       | 100           | <b>DE17-3007DBM38</b>   |
|           | 5.5      | 10      | 5       | 100           | <b>DE17-3007DBM310</b>  |
|           | 5.5      | 12      | 6       | 100           | <b>DE17-3007DBM312</b>  |
|           | 5.5      | 15      | 7.5     | 100           | <b>DE17-3007DBM315</b>  |
|           | 5.5      | 18      | 9       | 100           | <b>DE17-3007DBM318</b>  |
|           | 5.5      | 20      | 9       | 100           | <b>DE17-3007DBM320</b>  |
|           | 5.5      | 25      | 10      | 100           | <b>DE17-3007DBM325</b>  |
|           | 5.5      | 30      | 10      | 100           | <b>DE17-3007DBM330</b>  |
|           | 5.5      | 35      | 10      | 100           | <b>DE17-3007DBM335</b>  |
|           | 5.5      | 40      | 10      | 100           | <b>DE17-3007DBM340</b>  |
|           | 5.5      | 50      | 10      | 100           | <b>DE17-3007DBM350</b>  |

| d<br>mm   | SW<br>mm | H<br>mm | h<br>mm | Stand.-Packg. | Artikel-Nr.<br>Part-No. |
|-----------|----------|---------|---------|---------------|-------------------------|
| <b>M4</b> | 7        | 5       | 2.5     | 100           | <b>DE17-3007DBM45</b>   |
|           | 7        | 10      | 5       | 100           | <b>DE17-3007DBM410</b>  |
|           | 7        | 15      | 7.5     | 100           | <b>DE17-3007DBM415</b>  |
|           | 7        | 20      | 10      | 100           | <b>DE17-3007DBM420</b>  |
|           | 7        | 30      | 10      | 100           | <b>DE17-3007DBM430</b>  |