

GP Batteries

Data Sheet

Rechargeable Nickel Metal Hydride Battery

Model: GP75AAH

Revision History

Revision	Date	Initiator	Change Description
00	2014-5-24	Jackie Yu	1. New Form 2. Replace the 'PMS2076 R0'
01	2015-7-30	Jackie Yu	1. Revised Page 2: Rated capacity and typical capacity 2. Add charging retention

Prepared by	Checked by	Approver
RD Engineer	RD Manager	SM
SY Jiang	Jackie Yu	Vivian Fong
Date: 2015-7-30	Date: 2015-7-30	Date: 2015-7-30

GPI International Limited

Gold Peak Building, 8/F, 30 Kwai Wing Road,
Kwai Chung, New Territories, Hong Kong.
Tel: (852) 2484 3333 Fax: (852) 24805912
Email: gpii@goldpeak.com
Website: <http://www.gpbatteries.com>

Model No.: **GP75AAH**

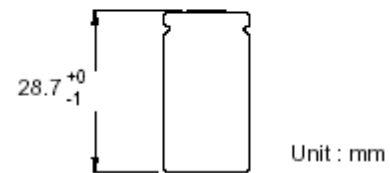
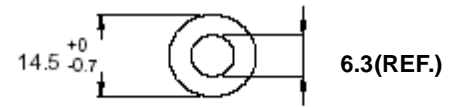

Type	: Rechargeable Nickel Metal Hydride Cylindrical Cell
Nominal Dimension (with Sleeve)	: $\Phi = 14.5\text{mm}$ H = 28.7mm
Applications	: Recommended discharge current 75 to 2250mA
Nominal Voltage	: 1.2V
Capacity	: Rated: 750mAh Typical: 770mAh When discharged at 150mA to 1.0V at 20°C
Charging Condition	: 75mA for 16 hrs at 20°C
Charging Retention	: 80% of Rated capacity after cell storage at 20°C for 12 months When discharged at 150mA to 1.0V at 20°C
Fast Charge	: 375mA to 750mA (0.5 to 1C) charge termination control recommended control parameters: - ΔV : 0-5mV DT/dt : 0.8°C/min (0.5 to 0.9C) 0.8 - 1°C/min (1C) TCO : 45 - 50°C Timer : 105% nominal input (for ref. only)
Service Life	: >500 cycles (IEC standard)
Continuous Overcharge	: 75mA maximum current for 1 year. No conspicuous deformation and/or leakage
Weight	: 15.0g
Internal Resistance	: Average 35m Ω upon fully charged (Max. 45m Ω) at 1000Hz
Max. Charging Voltage	: 1.5V at 75mA charging
Ambient Temperature Range	: Standard Charge : 0 to 45°C Fast Charging : 10 to 45°C Discharge : -20 to 50°C Storage : -20 to 35°C

Low Rate Discharge

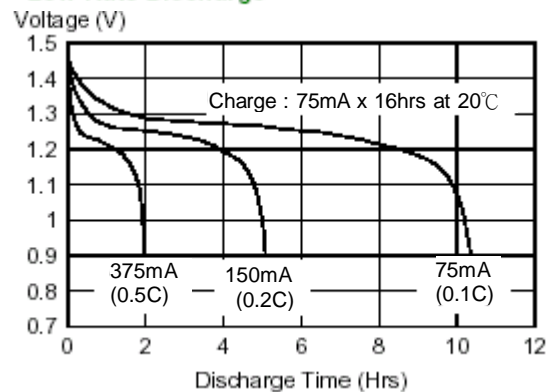

High Rate Discharge

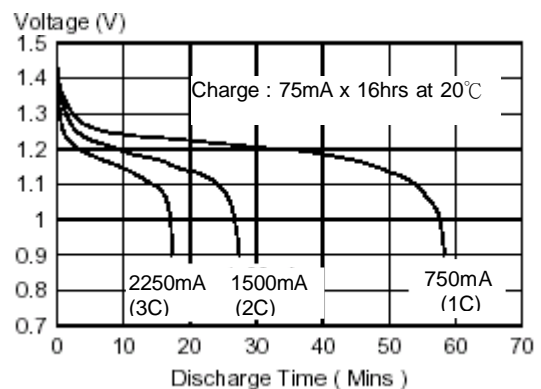

Fast Charge (Charge control required)

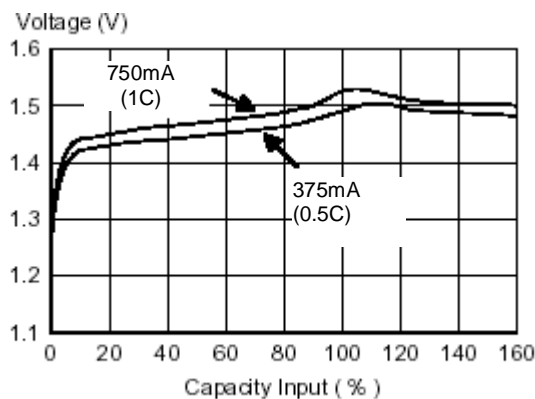

The information (subject to change without prior notice) contained in this document is for reference only and should not be used as a basis for product guarantee or warranty. For applications other than those described here, please consult your nearest GP Sales and Marketing Office or Distributors.