

# HITPOINT

TEL:8862-26013311

FAX:8862-26013898

NO.4 Lane 505, Zhongzheng Rd., Linkou Shiang, Taipei, Taiwan 24445 . R.O.C

## Piezo Electric Buzzer PK-27A35EPDGQ

(RoHS)

DATE:2012-3-8

### 1 . Electrical Characteristics

VER.:0

|                                |                             |
|--------------------------------|-----------------------------|
| Oscillation Frequency (KHz)    | 3.5 ±0.5                    |
| Operating Voltage (Vdc)        | 3 ~ 15                      |
| Rated Voltage (Vdc)            | 12                          |
| Current Consumption (mA/max.)  | 18 at Rated Voltage         |
| Sound Pressure Level (dB/min.) | 95 at 30cm at Rated Voltage |
| Tone/Pulse Rate                | Constant                    |
| LED Colour                     | GREEN                       |
| Operating Temperature ( °C)    | -20 ~ +70                   |
| Storage Temperature ( °C)      | -30 ~ +80                   |

### 2 . Dimensions and Material

#### 2-1 Shape

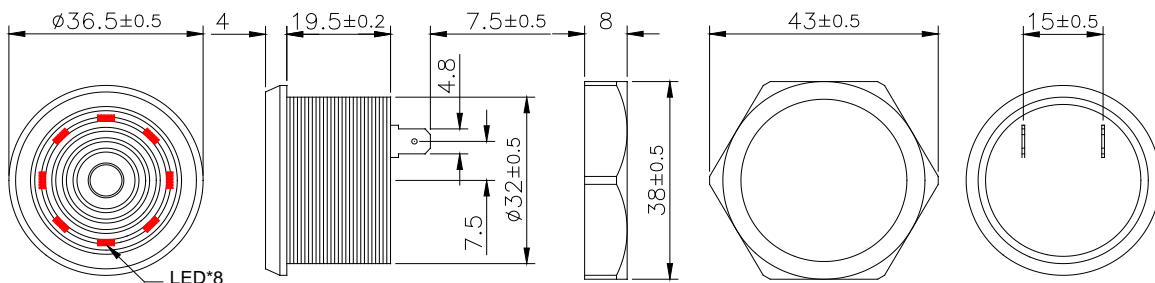

Unit : mm



# HITPOINT

TEL:8862-26013311

FAX:8862-26013898

NO.4 Lane 505, Zhongzheng Rd., Linkou Shiang, Taipei, Taiwan 24445 . R.O.C

## 2-2 Material

|               |  |
|---------------|--|
| Housing       | ABS 757 UL94HB plastic resin (Color : Hyaline) |
| Leading Pin   | Tin Plated Brass                               |
| Weight (Gram) | 21   |

## 3. TESTING METHOD

### · *Standard Measurement conditions*

Temperature:  $25 \pm 2$  °C Humidity: 45-60%

### · *Acoustic Characteristics*

The oscillation frequency, current consumption and sound pressure are measured by the measuring instruments shown below.

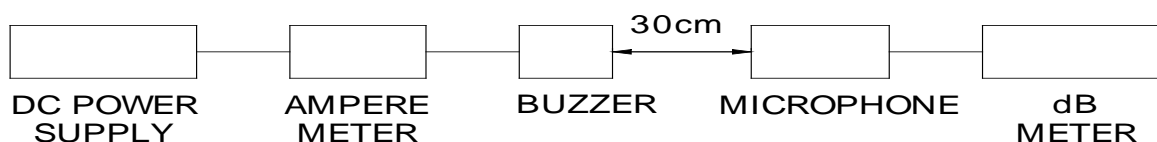

# HITPOINT

TEL:8862-26013311

FAX:8862-26013898

NO.4 Lane 505, Zhongzheng Rd., Linkou Shiang, Taipei, Taiwan 24445 . R.O.C

## 4. RELIABILITY

| <b>ITEMS</b>                      | <b>METHOD OF TEST AND MEASUREMENTS</b>  | <b>PERFORMANCE</b>                    |
|-----------------------------------|---|---------------------------------------|
| <i>Coldness<br/>withstanding</i>  | <i>After 98 hours of being exposed to -30 °C<br/>environment, should be returned to normal<br/>environment for 2 hours, then re-proceed to test.</i>                              | <i>No abnormality<br/>shall exist</i> |
| <i>Hotness<br/>withstanding</i>   | <i>After 98 hours of being exposed to +80 °C<br/>environment, should be returned to normal<br/>environment for 2 hours, then re-proceed to test.</i>                              | <i>No abnormality<br/>shall exist</i> |
| <i>Humidity<br/>withstanding</i>  | <i>After 98 hours of being exposed to 40 °C 95%RH<br/>environment in actual operation, should be<br/>returned to normal environment for 2 hours, then<br/>re-proceed to test.</i> | <i>No abnormality<br/>shall exist</i> |
| <i>Durability</i>                 | <i>Testing after 1,000 hours actual continuous<br/>operation.(at standard measurement conditions)</i>   | <i>No abnormality<br/>shall exist</i> |
| <i>Drop<br/>withstanding</i>      | <i>A natural drop from 75cm high down to the<br/>ground.</i>  | <i>No abnormality<br/>shall exist</i> |
| <i>Vibration<br/>withstanding</i> | <i>Vibration of 2,000 cycles per minute, 2mm<br/>amplitude, applied in X, Y and Z directions for 30<br/>minutes each.</i>   | <i>No abnormality<br/>shall exist</i> |

## 5. PACKAGE METHOD

<1> 50pcs per box, Total 10 boxes per carton, total 500pcs per carton;

Volume: L\*W\*H=520\*335\*290mm

<2>N . W . : ; 11KGS ; G . W . : 13KGS ;

<3> RoHS Mark